

Forsta Visualizations May 2025 Release



Forsta Visualizations May 2025 Release 1

 1. Introduction 3

 2. Data management 4

Save import tasks without immediate scheduling or data import 4

 3. Data connectivity 5

Automatic Import of Scale Questions from Forsta Surveys (Decipher) 5

 4. Project administration 7

MFA Improvements 7

1.Introduction

This document describes new and improved features in the Forsta Visualizations May 2025 Release.

If you would like to know more about these features, please contact the support team at visualizationsSupport@forsta.com and they will be able to assist you.

Best Regards,
Forsta Team

2.Data management

Save import tasks without immediate scheduling or data import

We are pleased to announce the introduction of a new feature that allows admins to save import tasks without the necessity of scheduling or importing data simultaneously. This enhancement provides greater flexibility in configuring settings, preparing imports in advance, or delegating import tasks to other team members.

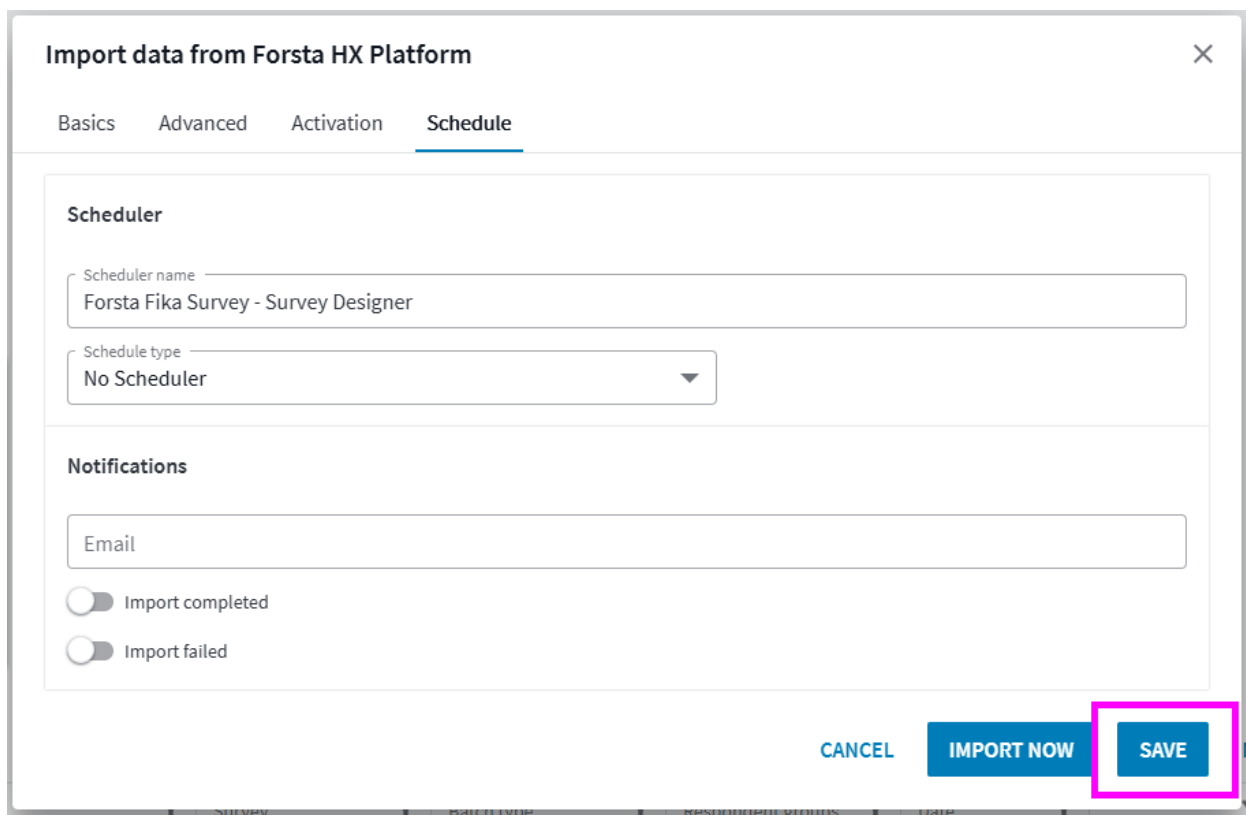

The screenshot shows a modal window titled "Import data from Forsta HX Platform" with a close button (X) in the top right corner. The window has four tabs: "Basics", "Advanced", "Activation", and "Schedule", with "Schedule" being the active tab. The "Schedule" tab contains two sections: "Scheduler" and "Notifications".

Scheduler

- Scheduler name**: A text input field containing "Forsta Fika Survey - Survey Designer".
- Schedule type**: A dropdown menu currently showing "No Scheduler".

Notifications

- Email**: A text input field.
- Import completed**: A toggle switch, currently turned off.
- Import failed**: A toggle switch, currently turned off.

At the bottom right of the modal, there are three buttons: "CANCEL", "IMPORT NOW", and "SAVE". The "SAVE" button is highlighted with a red rectangular border.

3.Data connectivity

Automatic Import of Scale Questions from Forsta Surveys (Decipher)

To expedite the transition from survey completion to reporting, we have developed a feature that automatically imports scale questions from Forsta Surveys (Decipher) when a rating is enabled on any question. Forsta Visualizations will automatically classify these questions as scale during the import process, utilizing the values selected in your survey as factors, ready for use in Categorical Mean calculations within any report.

This automatic classification will apply to all new metadata imported into Forsta Visualizations from Forsta Surveys (Decipher). To ensure the source of truth based on the ratings and values specified in your survey, enable the setting “Overwrite question type (scale/single choice) and mean value factors in project” within your import task. This setting will enforce updates to your scales and factors with each import, even if no new metadata is imported.

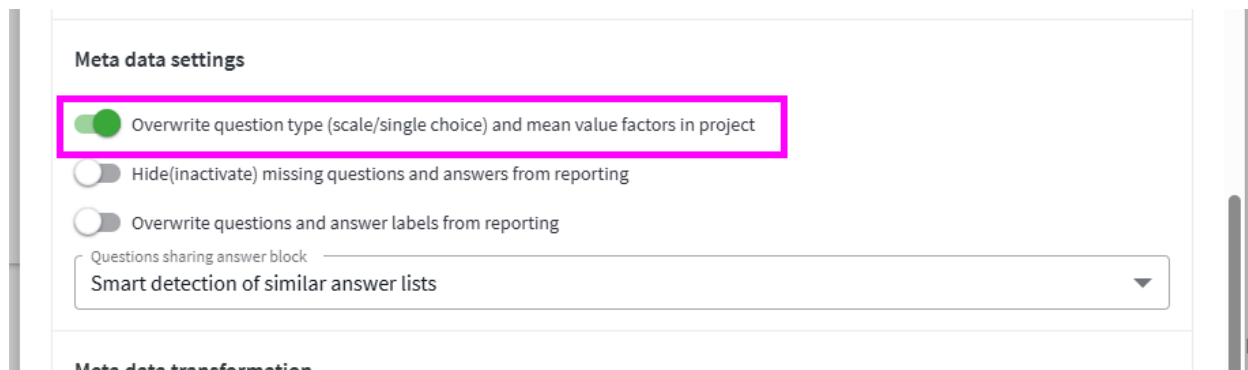

Meta data settings

- ☒ Overwrite question type (scale/single choice) and mean value factors in project
- ☐ Hide(inactivate) missing questions and answers from reporting
- ☐ Overwrite questions and answer labels from reporting

Questions sharing answer block —
Smart detection of similar answer lists ▼

Meta data transformation

Information message when enabling feature:

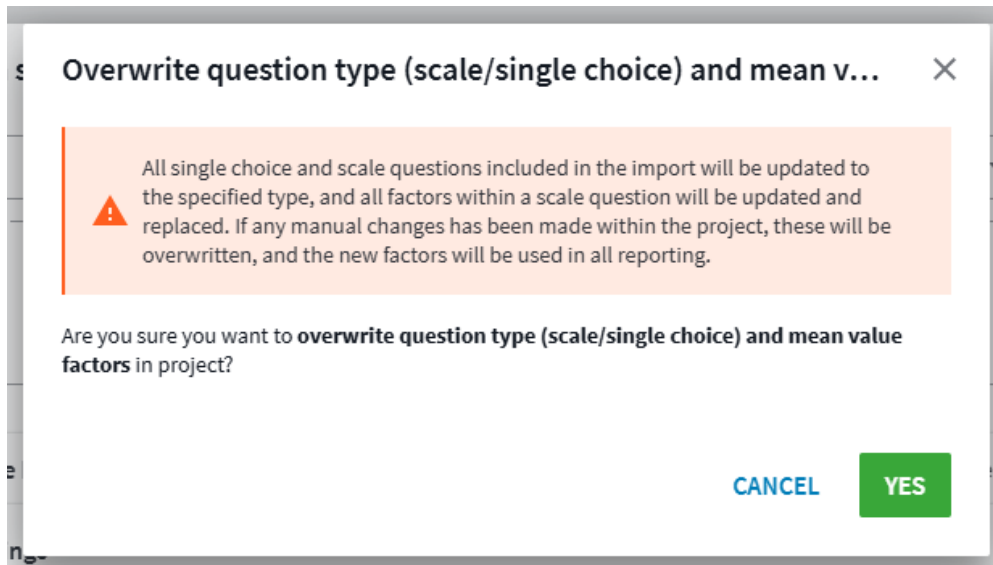

However, note that since the question type (scale/non-scale) and factors can be manually modified within Forsta Visualizations, the setting to overwrite these is disabled by default.

NOTE!

Ensure that ratings are not used for questions within your survey that should not be classified as scale questions within Forsta Visualizations.

4. Project administration

MFA Improvements

We are happy to announce improvements to our Multi-Factor Authentication (MFA) system. In addition to email verification, we have introduced app authentication for Admins, with plans to extend this option to all users in the future. Forsta recommends using Microsoft Authenticator.

After logging in with email verification, you will find a new option, "Authentication settings" under your account icon in the top right corner, where you typically log out.

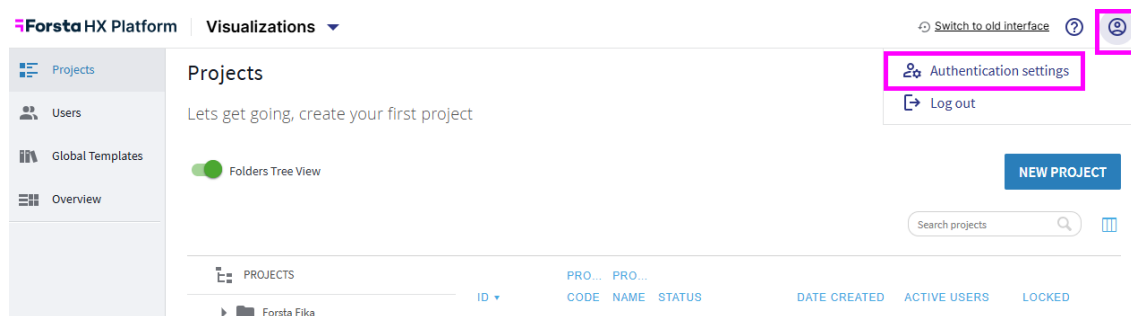

To enable app authentication, navigate to "Authentication settings," select "Set up authentication app," and follow the provided instructions.

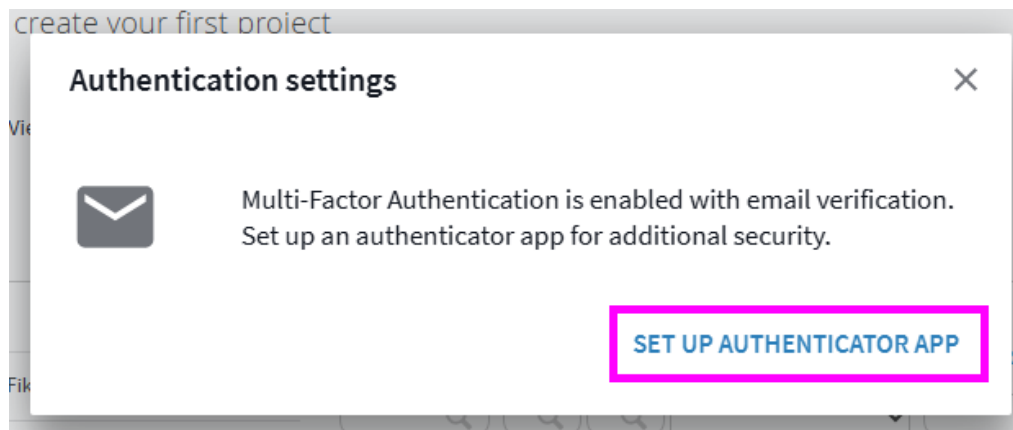

create your first project

Authentication settings

Add new MFA device.

- Start by installing the authenticator app of your choice. We recommend using Microsoft Authenticator.
- Open the app and follow the setup instructions. The actual steps may vary depending on the app you have installed.
- Scan the QR code provided or enter the code manually to complete the setup.

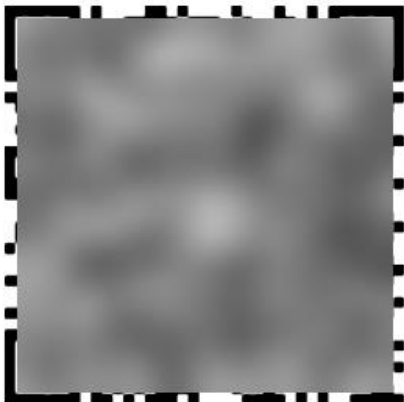

ENTER MANUALLY

- Enter and submit the confirmation code generated by the authenticator app.

[SUBMIT](#)

Once an authentication app is connected to your user account, email will no longer be the primary authentication method. However, you can still request email authentication during login if preferred.

Forsta Visualizations

Enter your verification code

CONTINUE

Click [here](#) to receive verification code via email

Within "Authentication settings" you can remove the authentication app and revert to email as the primary method, even if an app is connected to your user account.

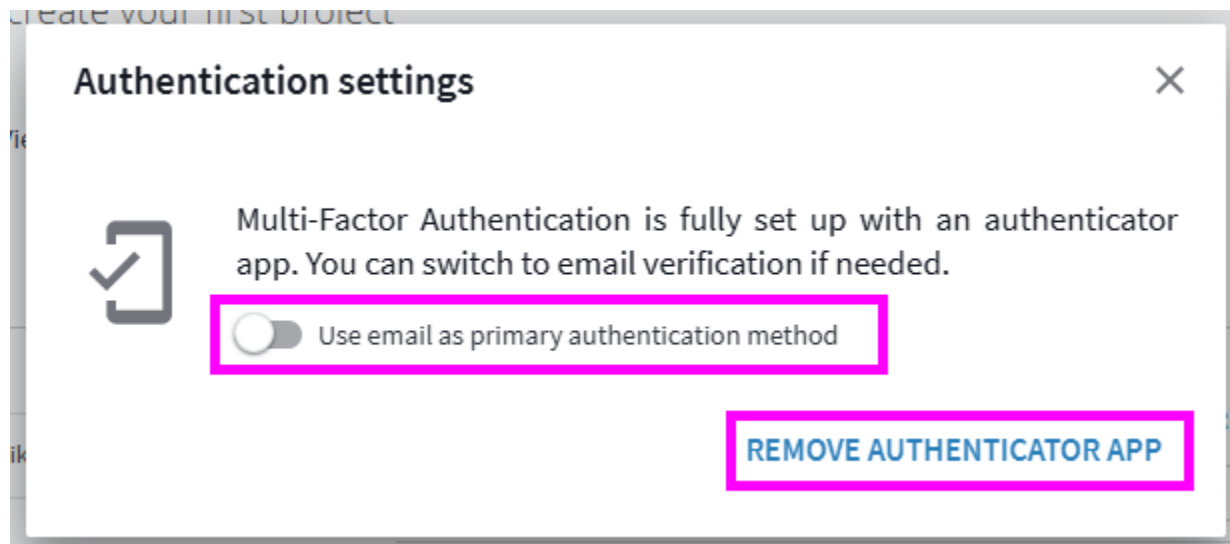

To completely remove the app connection, follow the instructions within Forsta Visualizations. You can then configure a new connection/app as needed.